

Datasheet for #sbcw1945 UP

Recommendations:

Please read the starter kit user manual (at least installation chapter 5), if available, and have a look at the FAQ at <http://www.alpeslasers.ch/alfaq.pdf>

WARNING: Operating the laser with higher current or voltage than specified in this document may cause damage and will result in loss of warranty, unless Alpes Lasers has permitted to do so!

WARNING: Beware of the polarity of the laser. This laser has to be powered with negative current on the laser contact (= bonding pad, corresponding to the label "laser" on the LLH) and the positive current on the base contact (= submount, corresponding to the label "base" on the LLH). To use with a power-supply ILX Lightwave LDX-3232 or equivalent.

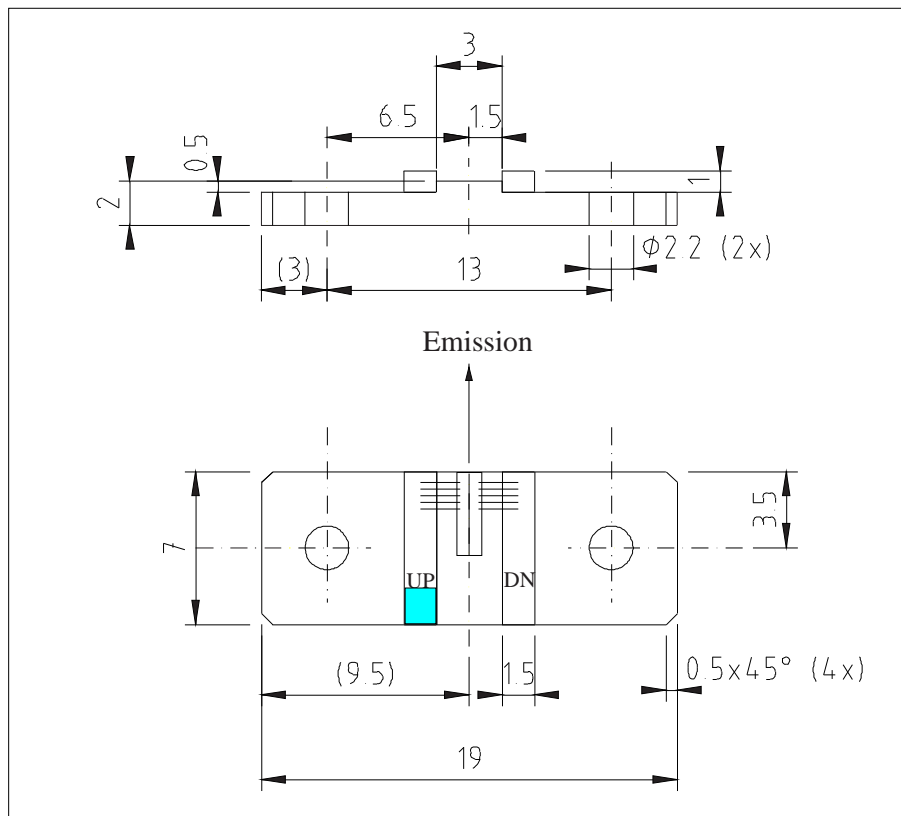

Figure 1: Support mounting for #sbcw1945 UP (please note that the laser is connected to the UP pad drawn in blue)

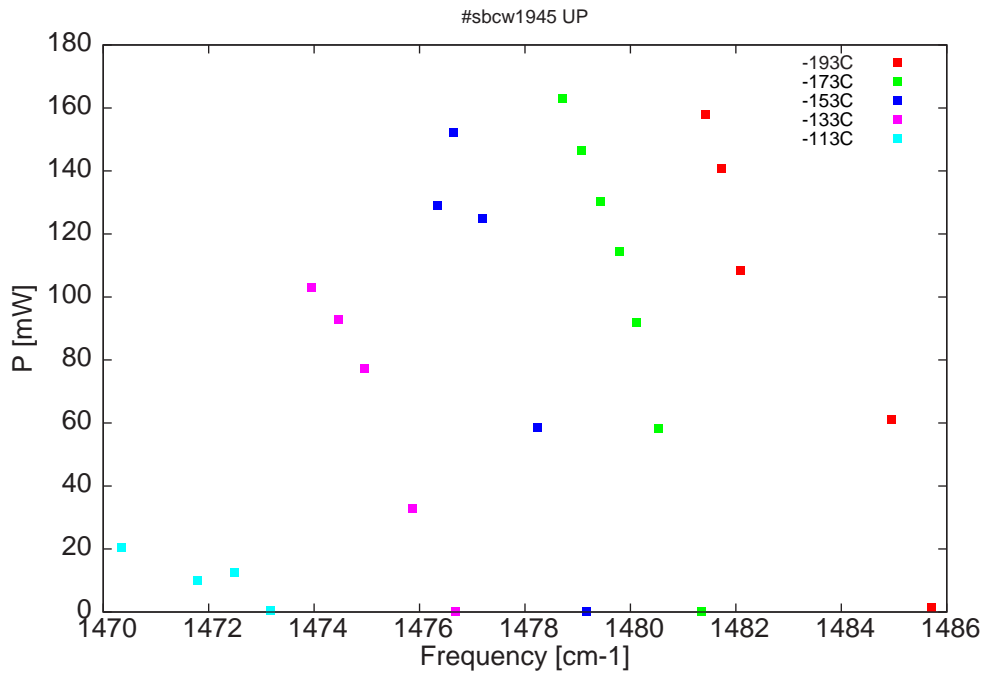

Figure 2: Output power as a function of the singlemode emission frequencies and temperatures

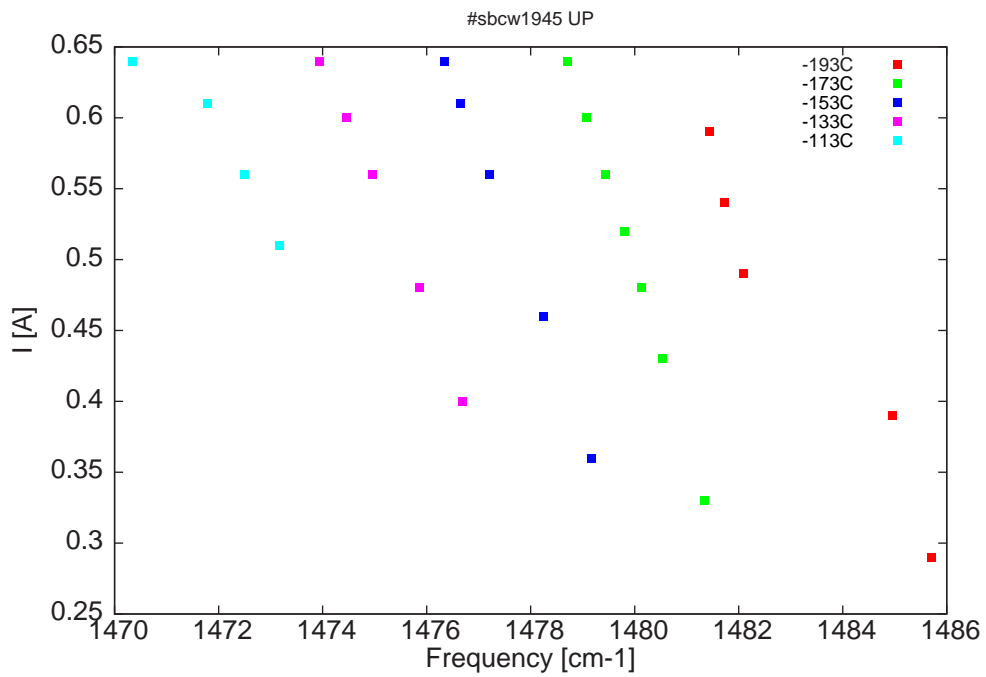

Figure 3: Applied DC current as a function of singlemode emission frequencies and temperatures

λ [nm]	ν [cm ⁻¹]	P[mW]	Temp[°C]	U_{LASER} [V]	I[A]
6730.8	1485.7	1.3	-193	10	0.29
6734.2	1485	61	-193	10.1	0.39
6747.2	1482.1	108.3	-193	10.3	0.49
6748.8	1481.7	140.9	-193	10.3	0.54
6750.2	1481.4	158.1	-193	10.4	0.59
6750.6	1481.3	0.1	-173	9.7	0.33
6754.3	1480.5	58.1	-173	9.9	0.43
6756.2	1480.1	91.9	-173	9.9	0.48
6757.7	1479.8	114.4	-173	10	0.52
6759.3	1479.4	130.4	-173	10	0.56
6761	1479.1	146.4	-173	10.1	0.6
6762.7	1478.7	162.9	-173	10.1	0.64
6760.6	1479.2	0.1	-153	9.5	0.36
6764.8	1478.2	58.7	-153	9.6	0.46
6769.5	1477.2	124.8	-153	9.7	0.56
6772.1	1476.7	152.1	-153	9.8	0.61
6773.5	1476.3	129.1	-153	9.8	0.64
6771.9	1476.7	0.1	-133	9.2	0.4
6775.7	1475.9	32.9	-133	9.3	0.48
6779.9	1475	77.1	-133	9.5	0.56
6782.2	1474.5	92.9	-133	9.5	0.6
6784.5	1473.9	102.8	-133	9.6	0.64
6788.1	1473.2	0.5	-113	9.1	0.51
6791.2	1472.5	12.6	-113	9.2	0.56
6794.4	1471.8	10.1	-113	9.3	0.61
6801.1	1470.4	20.6	-113	9.4	0.64

Table 1 : singlemode optical output power as function of operating parameters

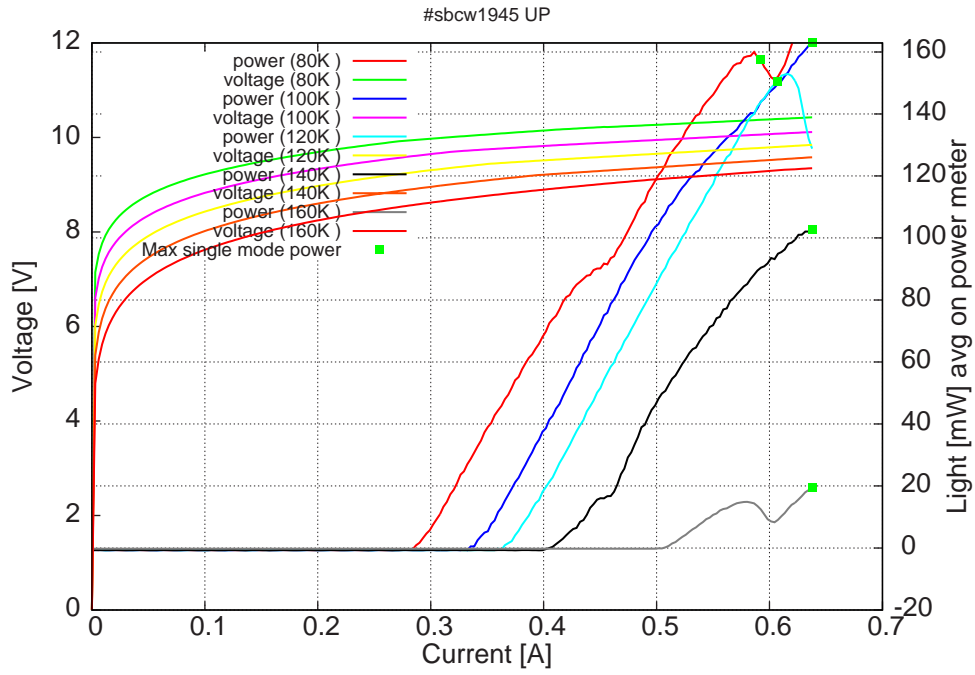

Figure 4: peak voltage and average power vs peak current in continuous-wave operation (the solid squares indicate the maximum singlemode emitted power)

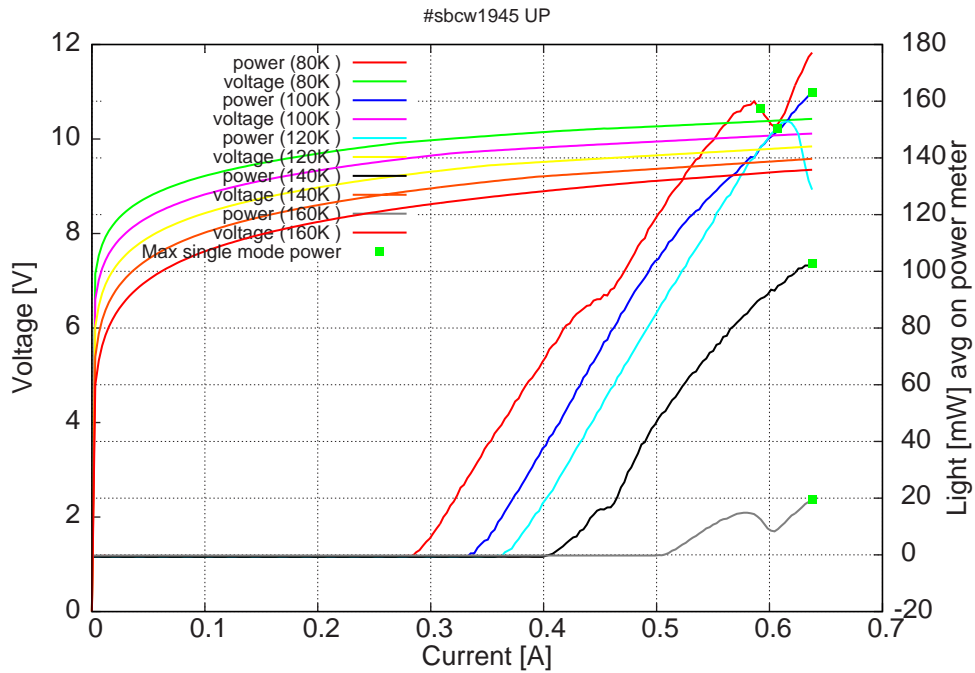
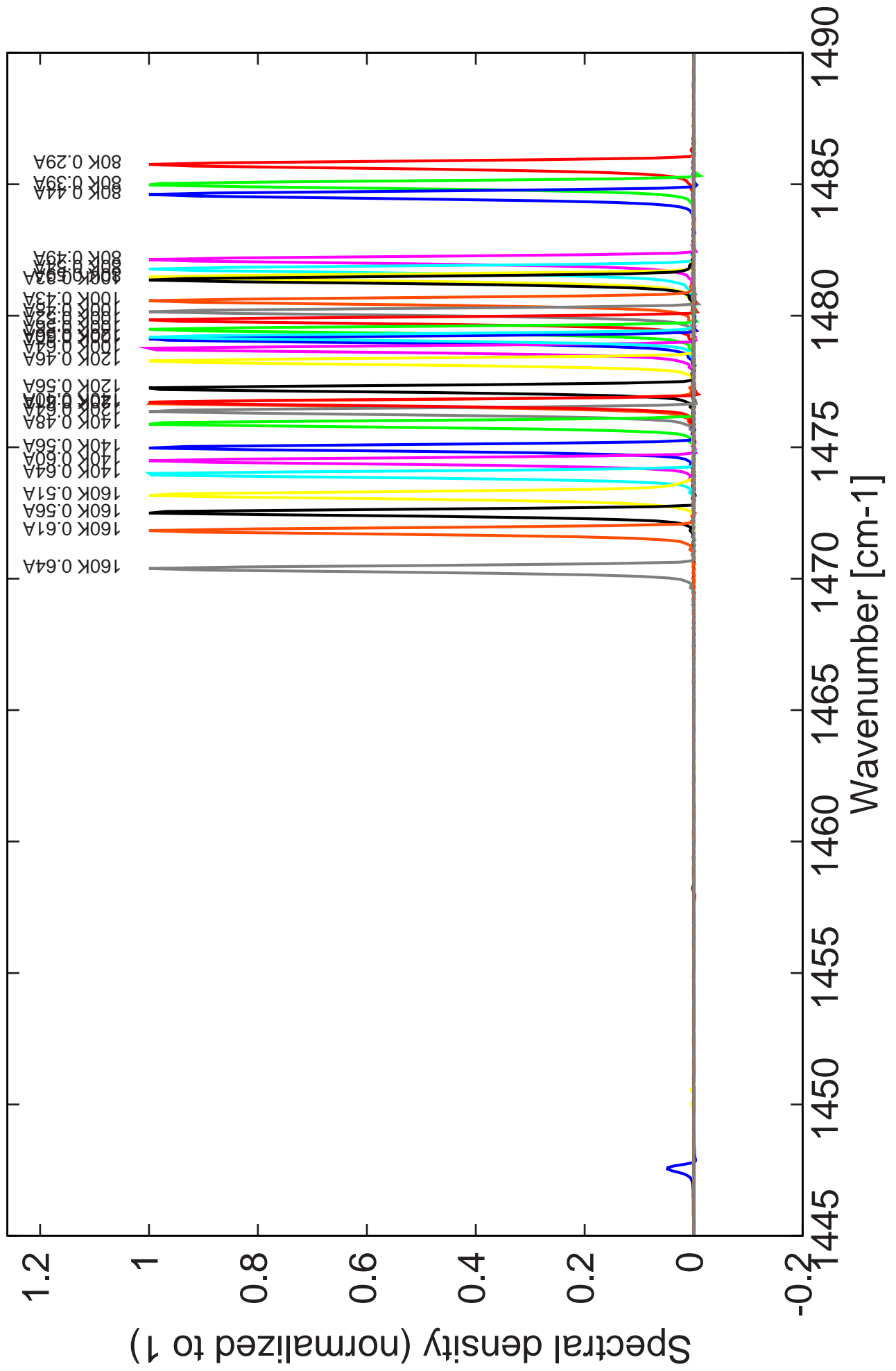

Figure 5: peak voltage and average power vs peak current in continuous-wave operation (including the multimode region)

Note: at 80K: $I_{th}=290\text{mA}$ / $V_{th}=9.9\text{V}$ (2-wires measurements). Maximum operation current: 640mA for all temperatures.

Figure 4: spectra at different temperatures for various DC currents



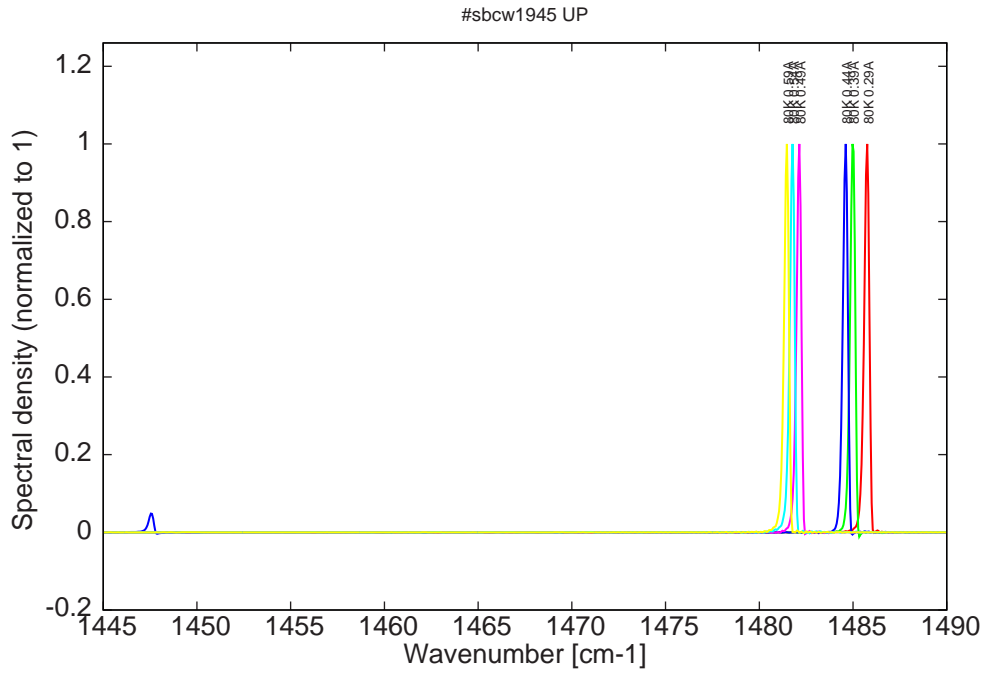

Figure 6: spectra at 80K for various DC currents (bimode around 0.44A)

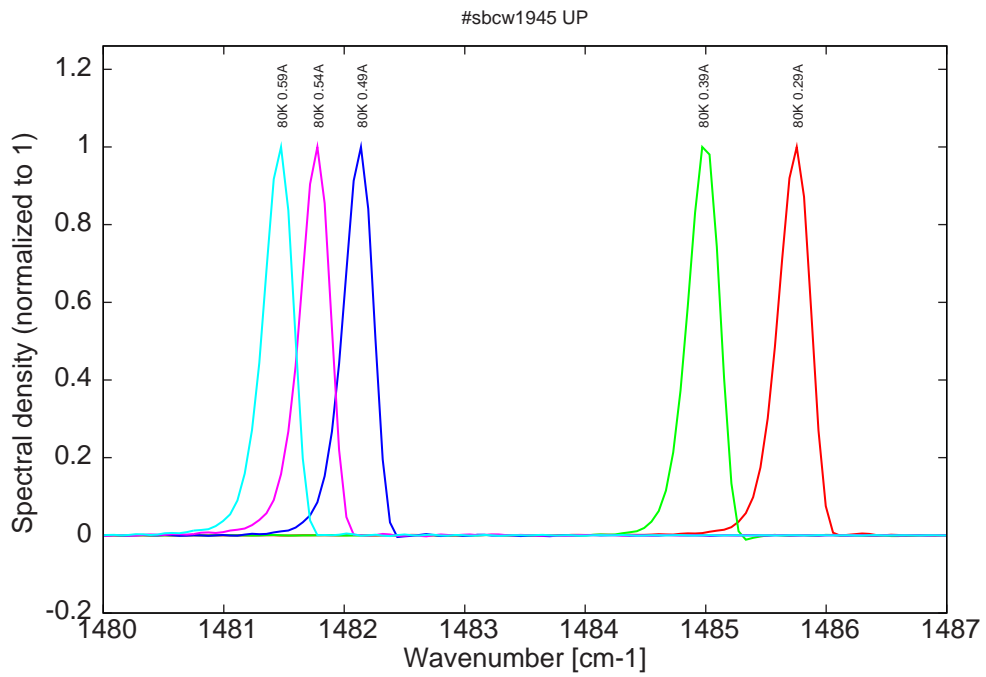

Figure 7: spectra at 80K for various DC currents (monomode range, but lower currents spectra on another mode compared to higher temperatures, see Fig. 1)

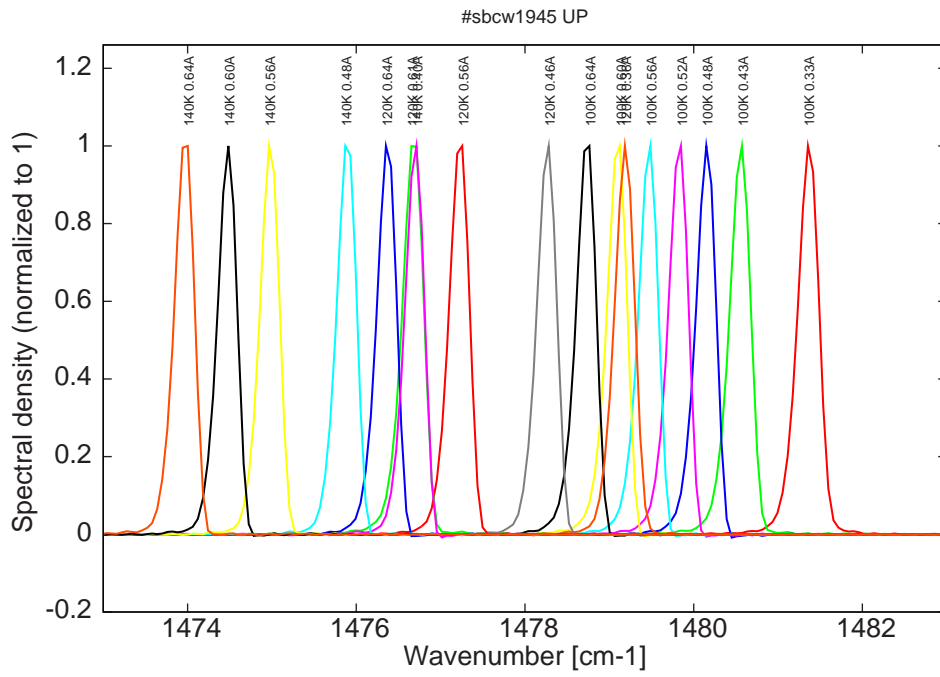

Figure 8: spectra between 100K and 140K for various DC currents (all monomode)

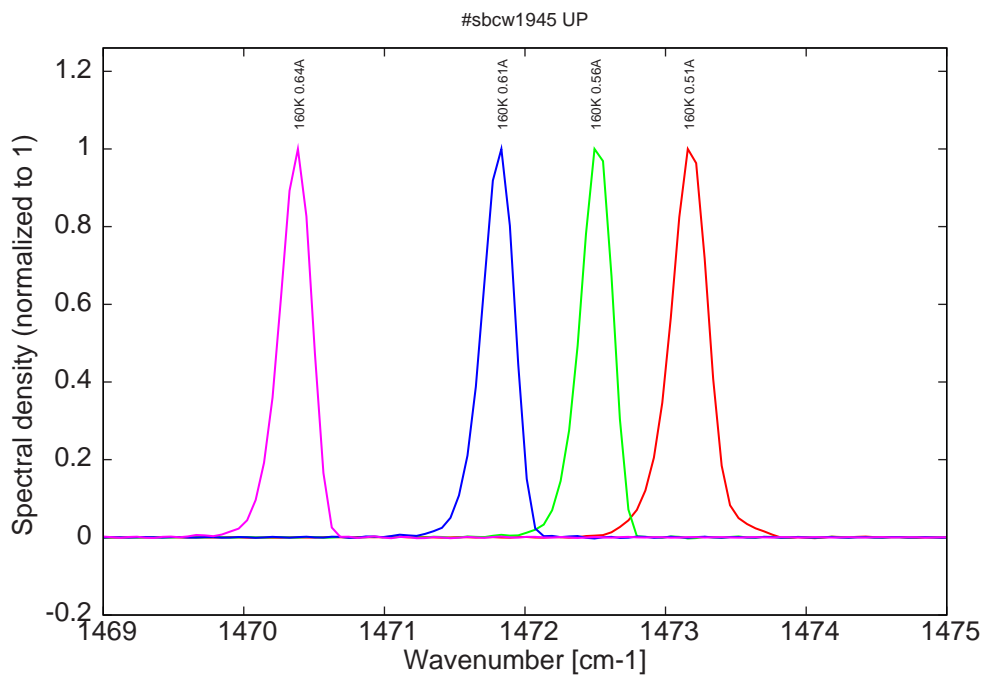

Figure 9: spectra at 160K for various DC currents (all monomode, but with mode jumping for $I > 0.61A$, see Fig. 1)